

# UTILITY ALLOCATION IN STREETS

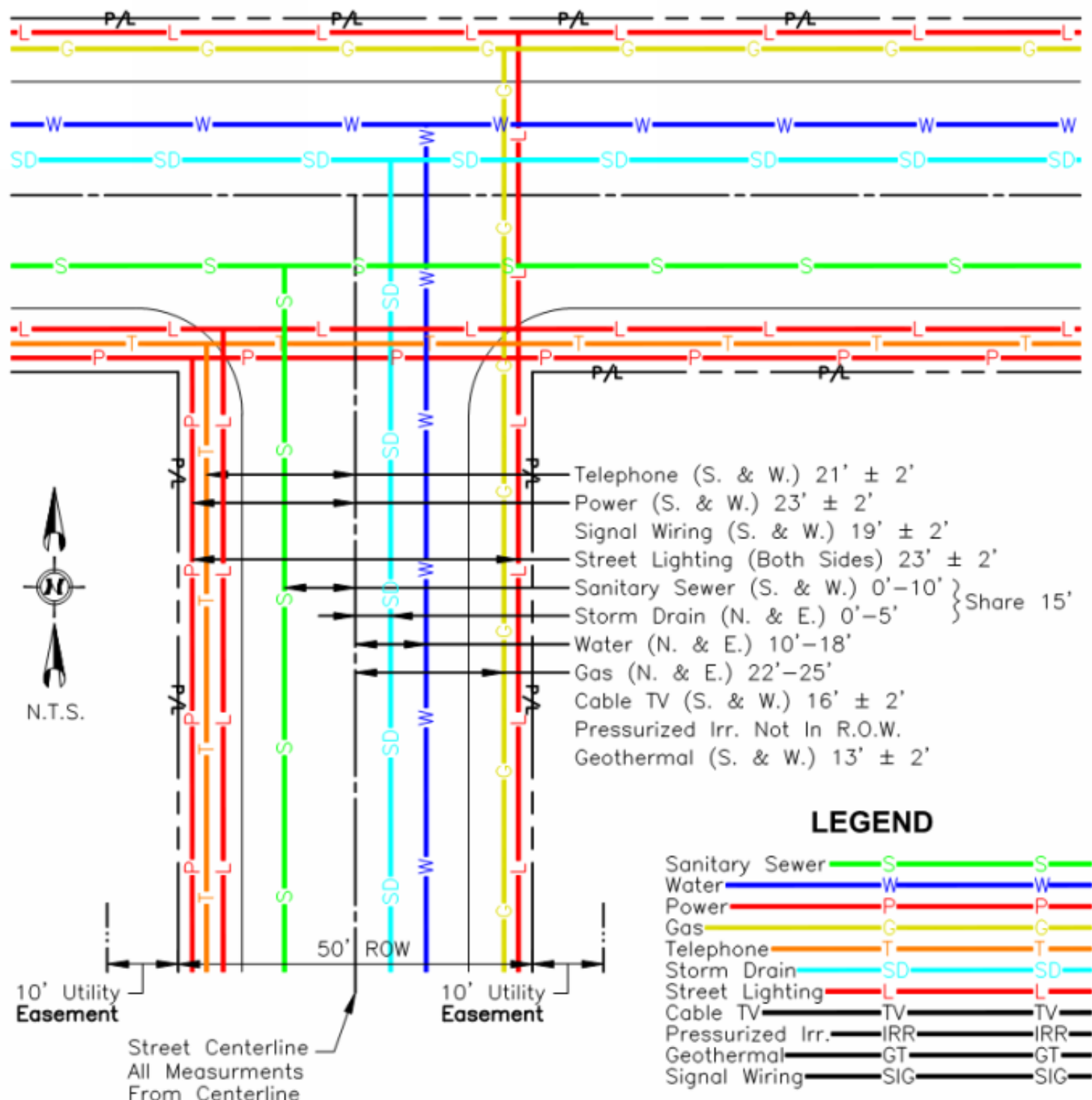

- NOTES:**
- 1) Written Approval Required For Variance
  - 2) Major Arterial Or 'A' Typical Street Send Design To All Parties For Comment
  - 3) Even When In Proper Space Allocation Attempt To Keep A Reasonable Working Distance Between Utilities - Suggested 3' Min.

**SEE ACHD POLICY 6007.12.4: ALIGNMENT OF FACILITIES FOR MORE INFORMATION**

